

FACTORY FURNITURE

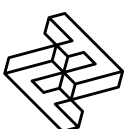

Ribbon Bench - Twist & Flat

OPERATION & MAINTENANCE MANUAL



Introduction

Design

Design, shop drawings and development by
Factory Furniture Ltd.

Manufacture

Factory Furniture manufactured components. Products are assembled in Factory workshops, checked and dispatched ready for installation. Replacement products or components thereof should be ordered direct from Factory Furniture Ltd.

Copyright

The design copyright for the product and drawing copyright remains the sole property of Factory Furniture Ltd.

General Specifications

Ribbon Twist Bench

Metric L 3110mm | width 1200mm | height 545mm*
Imperial length 10' 2½" | width 3' 11" | height 1' 9½"

Approx Weight 285kg

Fixing Centres 2310mm (7' 7") x 650mm (2' 1½")

Ribbon Flat Bench

Metric L 3110mm | width 1200mm | height 500mm*
Imperial length 10' 2½" | width 3' 11" | height 1' 7½"

Approx Weight 288kg

Fixing Centres 2310mm (7' 7") x 650mm (2' 1½")

Materials & Finishes

Bench Slats

- Manufactured from FSC® certified tropical hardwood
- Profiled and left untreated as standard (*oil or microporous woodstain treatment available*)
- Supported on frame - attached with 2 no. fixing points each



Frame

- Manufactured from hot dipped galvanised mild steel with polyester powder coat finish (*powder coat colour grey as standard or to customer specification*). Stainless steel with satin polished finish option available
- Frame is an all welded construction
- 3 off bases anchored to frame using 4 no. fixing points each
- Bench is anchored to ground via bases using 2 no. zinc-coated M10 x 75mm sleeve anchors per base (6 no. total).

General Maintenance

(Recommended Schedule & Guidelines)

Daily/Weekly/Monthly (or as adopted)

Visual checks of bench slats and frame (if applicable) - check all items for superficial or physical damage.

Three Monthly

Clean all items as detailed below check all fixings are seated correctly; inspect timber for serious damage and splinters.

Six Monthly

Secure all fixings; full clean as detailed below; check that bench is firmly secured to the ground.

Specific Maintenance Details

FSC Timber

Clean with a stiff brush once per year, especially in more exposed locations, in order to prevent a verdigris type build up on the timber surface. Ideally this should be completed in early spring. During the cleaning stage, all exposed timber surfaces should be inspected for splits and splinters. Any splinters and graffiti should be removed and the surface sanded with 100 grit sandpaper in order to remove any uneven / sharp edges or surfaces.

During the first few months after installation the tannin naturally occurring in the timber may leach out and cause a brown staining on the bases. This may be removed with a light solution of household bleach and water.

Polyester Powder Coated & Galvanised

For general cleaning using a damp cloth and warm soapy water only. Scourers and abrasive cleaners are NOT suitable for this type of finish and may damage it. Before using any cleaning agents to remove graffiti etc. try on a small, inconspicuous area first to avoid causing more unsightly damage.

Stainless Steel (polished stainless steel only)

Clean as required, but at least every three months, using a stainless steel polish and a lint free cloth. To remove ground in dirt, a stainless steel finishing pad may be required.

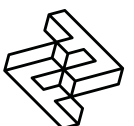

Repairs

FSC Timber

For light damage, please see section on specific maintenance details above. For instances of heavy damage, the timber item should be replaced. Please order against the part number reference in the reordering section towards the end of this manual

Polyester Powder Coated & Galvanised Surfaces

For light damage (scratches, chips etc.) repair using touch-up paint to match original colour (available from Factory Furniture Ltd). Paint application should be carried out in accordance with approved methods detailed by the paint manufacturer. Please note that it is advisable to use professional painters to achieve best results when touching up larger areas. Products for respraying larger areas are available from Factory Furniture Ltd.

Stainless Steel

Light damage (surface scratches etc.) can be removed using an emery pad (240 grit) and freeing oil such as 'WD40'. Care should be taken to follow the direction of the brushing grain. It is recommended that a trial repair be carried out on an unimportant surface first. No corrosive cleaners or other abrasives should be used. Any contamination, particularly carbon steel scuffs from vehicles, should be quickly removed to avoid corrosion

Heavy Damage

In the event of serious damage to any component, replacements should be ordered from Factory Furniture Ltd. In this event (or if the product needs to be disassembled for any reason), please contact Factory Furniture for detailed technical advice.

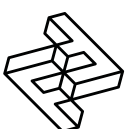

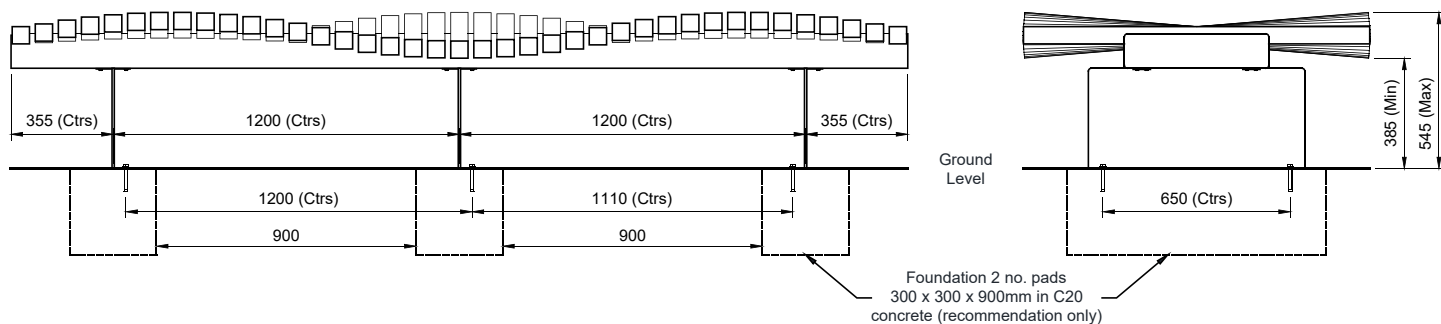

Ribbon Twist Bench

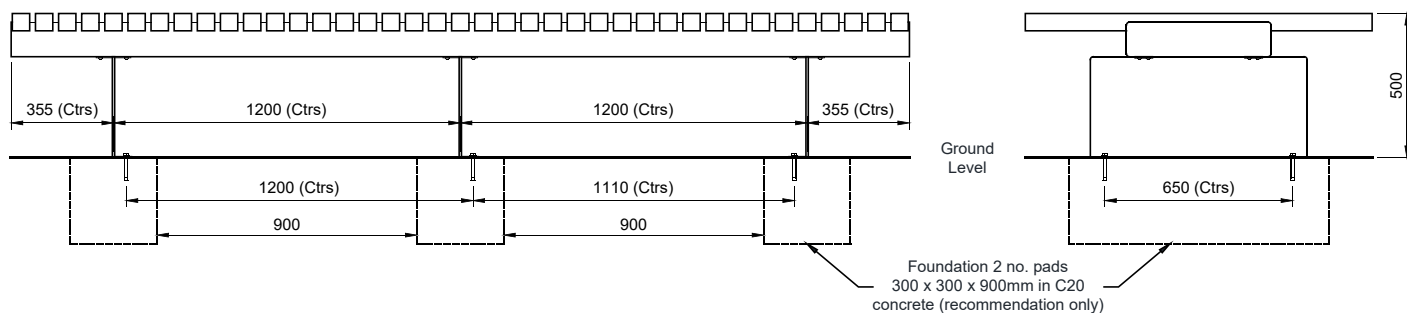

Ribbon Flat Bench

Installation Instructions

All installation works to be carried out by competent personnel - install as complete unit.

Ribbon Twist Bench / Ribbon Flat Bench

1. Install suitable foundation pads (see illustration) each with top face at ground level
2. Position bench in correct orientation with bases centrally on foundation pads; then mark hole positions through base plate
3. Remove the bench; drill holes $\varnothing 12\text{mm} \times 90\text{mm}$ deep (or as bolt manufacturer's recommendations)
4. Clear debris from holes
5. Reposition bench unit and fix to foundation pads using 2 no. zinc-coated M10 x 75mm sleeve anchors per base tightened to 50Nm (or as per manufacturer's instruction). Ensure bench remains level during fixing process
6. Check level and reinstate ground if necessary

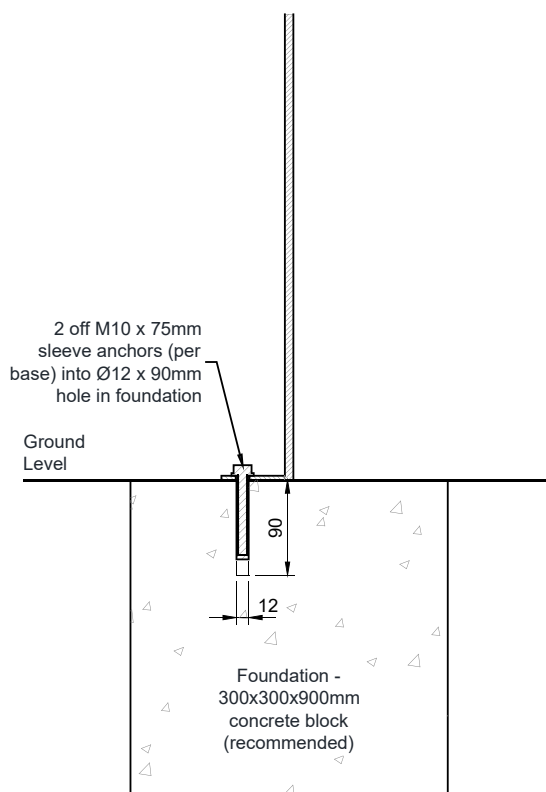

IMPORTANT NOTE

Ensure that stainless steel is protected during site cutting of stone – contamination from disc cutters will produce corrosion on stainless steel components.

5 Pioneer Road, Faringdon,
Oxfordshire SN7 7BU
+44 (0)1367 242731
hello@factoryfurniture.co.uk

