

# FACTORY FURNITURE

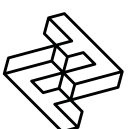

## Util Bench & Seat

### OPERATION & MAINTENANCE MANUAL



# Introduction

## Design

Design, shop drawings and development by Factory Furniture Ltd.

## Manufacture

Factory Furniture manufactured components. Products are assembled in Factory workshops, checked and dispatched ready for installation. Replacement products or components thereof should be ordered direct from Factory Furniture Ltd.

## Copyright

The design copyright for the product and drawing copyright remains the sole property of Factory Furniture Ltd.

# General Specifications

## Bench

*Metric* length 1800mm | width 470mm | height 450mm\*  
*Imperial* length 5' 11" | width 1' 6½" | height 1' 5½"

\*Not including +100mm below ground level for sub-surface fix option

**Approx Weight** 33kg

**Fixing Centres** 1760mm (5' 9½") x 340mm (1' 1½")

## Seat (arm option available)

*Metric* length 1800mm | width 550mm | height 890mm\*  
*Imperial* length 5' 11" | width 1' 9½" | height 2' 11"

\*Not including +100mm below ground level for sub-surface fix option

**Approx Weight** 57kg (61kg with arms)

**Fixing Centres** 1760mm (5' 9½") x 410mm (1' 4")

# Materials & Finishes

## Seat & Back Slats

- Manufactured from FSC® certified tropical hardwood (other FSC timber options available upon request).
- Profiled and left untreated as standard (oil or microporous woodstain treatment available on request)
- Supported on frame and attached with 8 no. fixing points per slat



## Frame (including arms if supplied)

- Manufactured from stainless steel square section tubing with satin polished finish
- Anchored using 4 no. zinc-coated M10 x 75mm sleeve anchors per bench / seat (1 no. per leg)

# General Maintenance

(Recommended Schedule & Guidelines)

## Daily/Weekly/Monthly (or as adopted)

Visual checks of slats and frame - check all items for superficial or physical damage.

## Three Monthly

Clean all items as detailed below check all fixings are seated correctly; inspect timber for serious damage and splinters.

## Six Monthly

Secure all fixings; full clean as detailed below; check that bench / seat is firmly secured to the ground.

# Specific Maintenance Details

## FSC Timber

Clean with a stiff brush once per year, especially in more exposed locations, in order to prevent a verdigris type build up on the timber surface. Ideally this should be completed in early spring. During the cleaning stage, all exposed timber surfaces should be inspected for splits and splinters. Any splinters and graffiti should be removed and the surface sanded with 100 grit sandpaper in order to remove any uneven / sharp edges or surfaces.

*During the first few months after installation the tannin naturally occurring in the timber may leach out and cause a brown staining on the bases. This may be removed with a light solution of household bleach and water.*

## Stainless Steel (polished stainless steel only)

Clean as required, but at least every three months, using a stainless steel polish and a lint free cloth. To remove ground in dirt, a stainless steel finishing pad may be required.

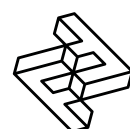

# Repairs

## **FSC Timber**

For light damage, please see section on specific maintenance details above. For instances of heavy damage, the timber item should be replaced. Please order against the part number reference in the reordering section towards the end of this manual

## **Stainless Steel**

Light damage (surface scratches etc.) can be removed using an emery pad (240 grit) and freeing oil such as 'WD40'. Care should be taken to follow the direction of the brushing grain. It is recommended that a trial repair be carried out on an unimportant surface first. No corrosive cleaners or other abrasives should be used. Any contamination, particularly carbon steel scuffs from vehicles, should be quickly removed to avoid corrosion

## **Heavy Damage**

In the event of serious damage to any component, replacements should be ordered from Factory Furniture Ltd. In this event (or if the product needs to be disassembled for any reason), please contact Factory Furniture for detailed technical advice.

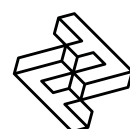

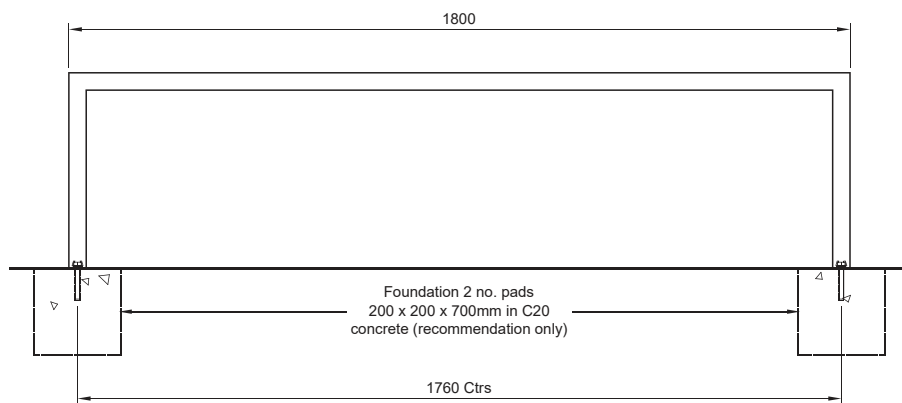

*Bench (Surface Fix)*

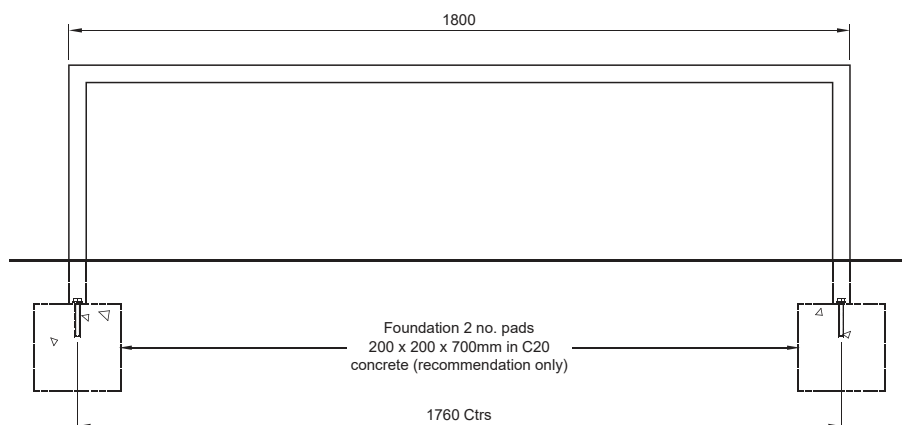
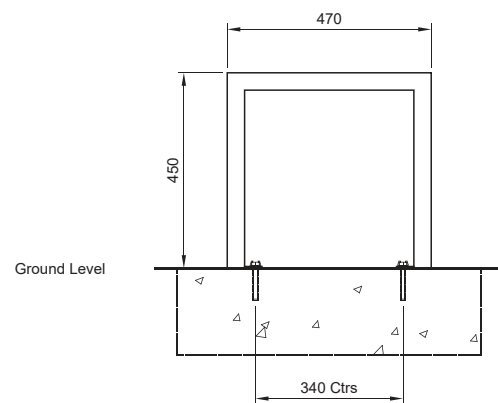

*Bench (Sub-surface Fix)*

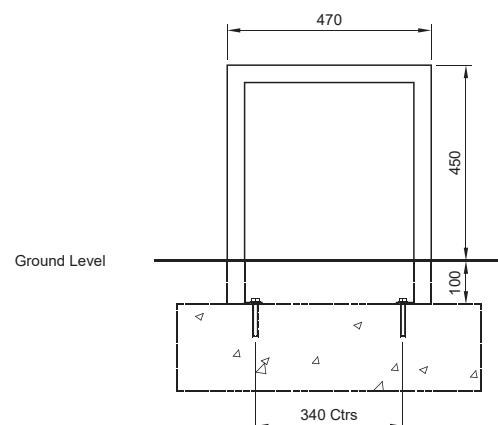

## Installation Instructions

**All installation works to be carried out by competent personnel - install as complete unit.**

### Util Bench

*(Surface & sub-surface fix options)*

1. Install suitable foundation pads (see illustration) each with top face at ground level (or with top face 100mm below ground level for sub-surface fix)
2. Position bench in correct orientation with bases centrally on foundation pads; then mark hole positions through fixing lugs.
3. Remove the bench; drill holes Ø12mm x 75mm deep (or as bolt manufacturer's recommendations).
4. Clear debris from holes.
5. Reposition bench unit and fix to foundation pads using 4 no.

zinc-coated M10 x 75mm sleeve anchors tightened to 50Nm (or as per manufacturer's instruction). Ensure bench remains level during fixing process.

6. **\*\*Surface fix only\*\*** Hammer an anti-vandal armour ring over each bolt head to prevent tampering.
7. Check level (and reinstate ground level if necessary - sub-surface fix)

### IMPORTANT NOTE

Ensure that stainless steel is protected during site cutting of stone – contamination from disc cutters will produce corrosion on stainless steel components.

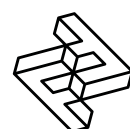
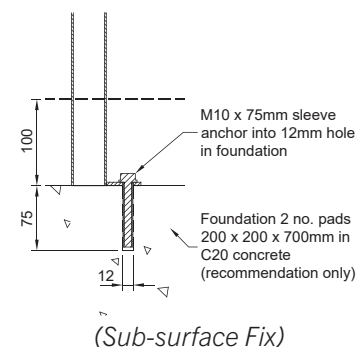
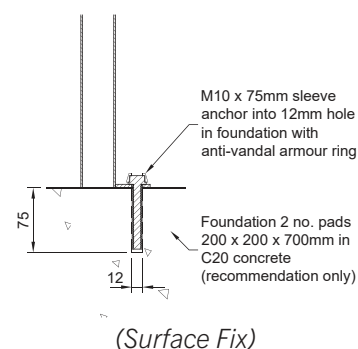

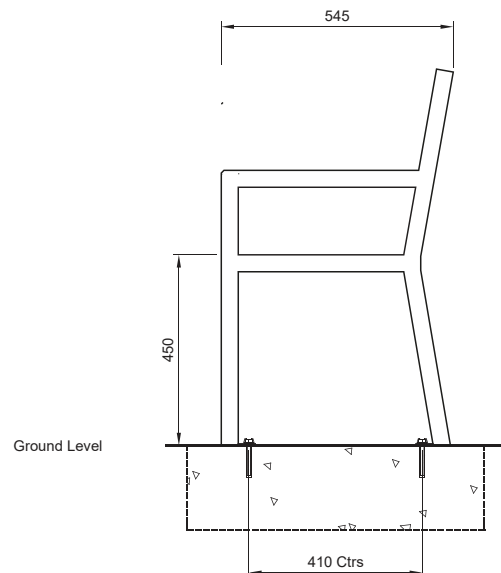
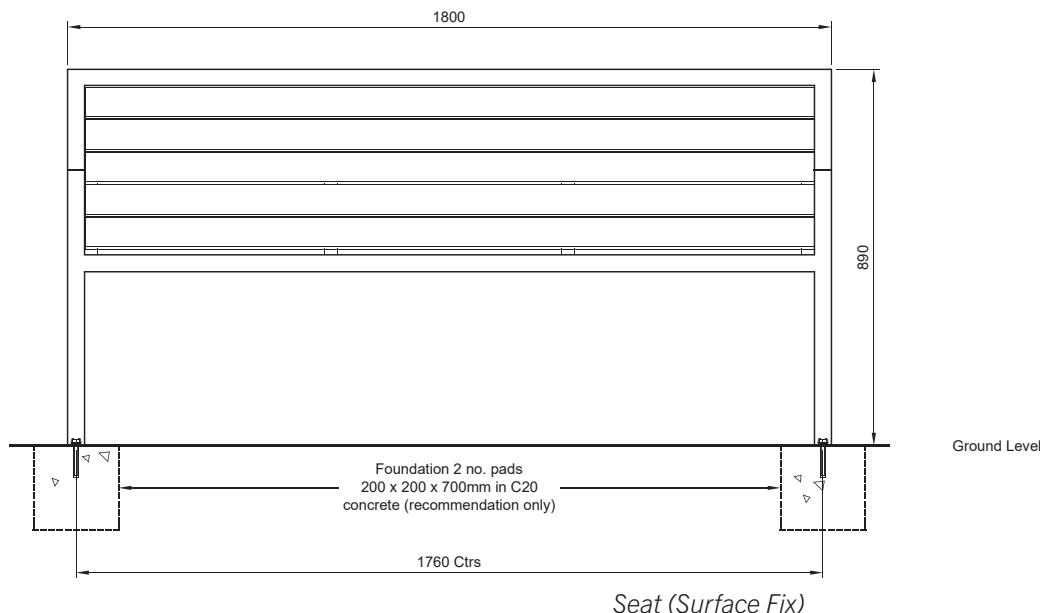

## Installation Instructions

**All installation works to be carried out by competent personnel - install as complete unit.**

### Util Seat

*(Surface fix option)*

1. Install suitable foundation pads (see illustration) each with top face at ground level
2. Position seat in correct orientation with bases centrally on foundation pads; then mark hole positions through fixing lugs
3. Remove the seat; drill holes  $\varnothing 12\text{mm} \times 75\text{mm}$  deep (or as bolt manufacturer's recommendations)
4. Clear debris from holes
5. Reposition seat unit and fix to foundation pads using 4 no. zinc-coated M10 x 75mm sleeve anchors tightened to 50Nm (or as per manufacturer's instruction). Ensure seat remains level during fixing process. Finally hammer an anti-vandal armour ring over each bolt head to prevent tampering
6. Check level

### IMPORTANT NOTE

Ensure that stainless steel is protected during site cutting of stone – contamination from disc cutters will produce corrosion on stainless steel components.

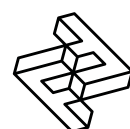
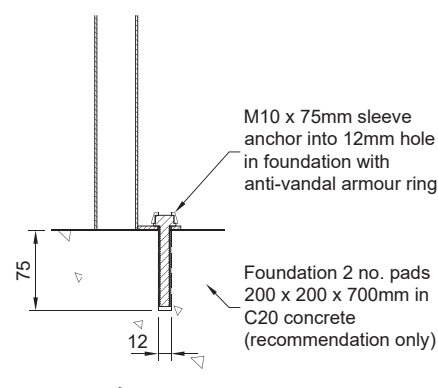

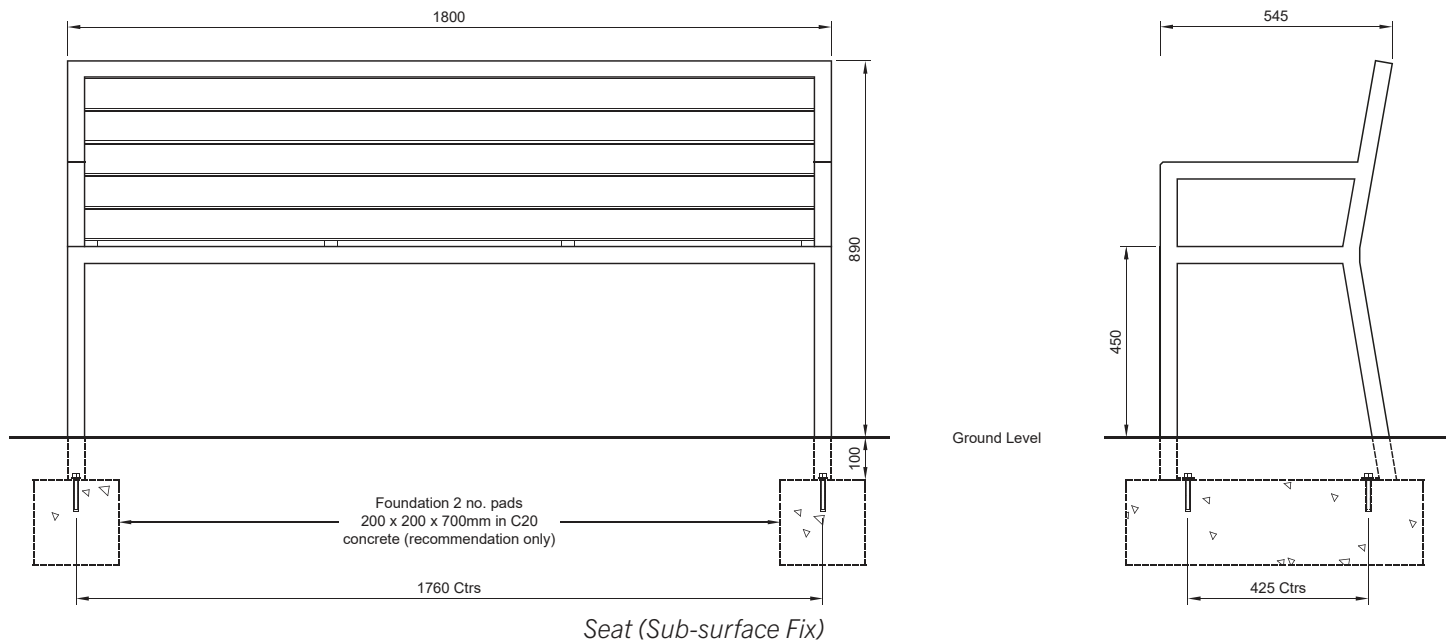

## Installation Instructions

**All installation works to be carried out by competent personnel - install as complete unit.**

### Util Seat

*(Sub-surface fix option)*

1. Install suitable foundation pads (see illustration) each with top face 100mm below ground level
2. Position seat in correct orientation with bases centrally on foundation pads; then mark hole positions through fixing lugs
3. Remove the seat; drill holes Ø12mm x 75mm deep (or as bolt manufacturer's recommendations)

4. Clear debris from holes
5. Reposition seat unit and fix to foundation pads using 4 no. zinc-coated M10 x 75mm sleeve anchors tightened to 50Nm (or as per manufacturer's instruction). Ensure seat remains level during fixing process.
6. Check level and reinstate ground level if necessary

### IMPORTANT NOTE

Ensure that stainless steel is protected during site cutting of stone – contamination from disc cutters will produce corrosion on stainless steel components.

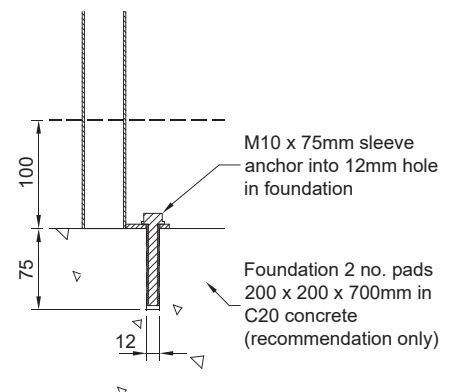

5 Pioneer Road, Faringdon,  
Oxfordshire SN7 7BU  
+44 (0)1367 242731  
hello@factoryfurniture.co.uk

**factoryfurniture.co.uk**

