



METRIC Planters
(Various heights)

Introduction

Design

Design, shop drawings and development by Factory Furniture Ltd

Manufacture

Factory Furniture manufactured components. Products are assembled in Factory workshops, checked and dispatched ready for installation. Replacement products or components should be ordered direct from Factory Furniture Ltd.

Copyright

The design copyright for the product and drawing copyright remains the sole property of Factory Furniture Ltd.

Contents

Spec Sheet

Planter	... 3
Trellis	... 4

Detailed Materials & Maintenance	... 5
----------------------------------	-------

Installation Instructions

Planter	... 6
Trellis	... 7

NBS Specifications	... 8
--------------------	-------

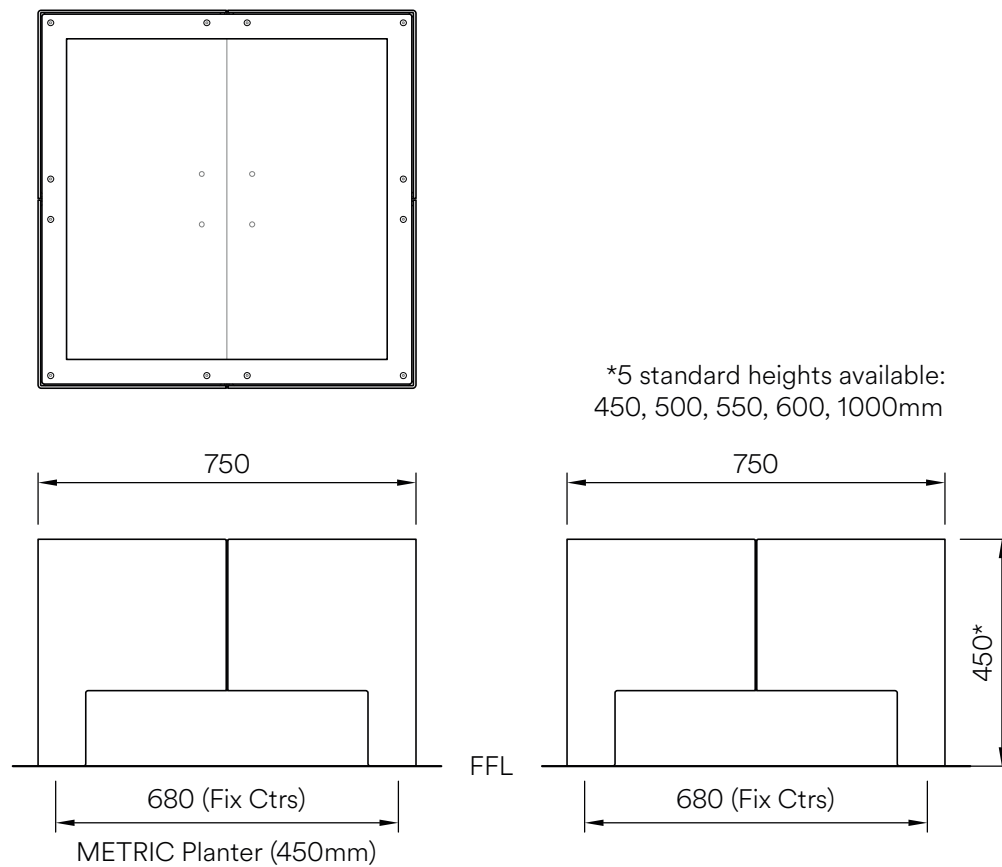

Composition

Frame - Mild steel

Liner - Mild steel

Finishes

Mild steel - Hot-dip galvanised (polyester powder-coat available (colour as per client's specification))

Dimensions

Metric L 750mm | width 750mm | height 450mm (Also 500, 550, 600 & 1000mm)

Imperial L 2' 5½" | width 2' 5½" | height 1' 6" (Also 1' 8", 1' 10", 2' 0" & 3' 4")

Approx weight

68kg (Also 76, 84, 92 & 180kg)

Planter capacity

90ltrs (Also 110, 130, 150, 315ltrs)

Handling

Please observe health & safety lifting guidelines. A forklift or crane will be required for off-loading and positioning of this product.

Maintenance

Depends on usage and position. All elements will require cleaning annually.

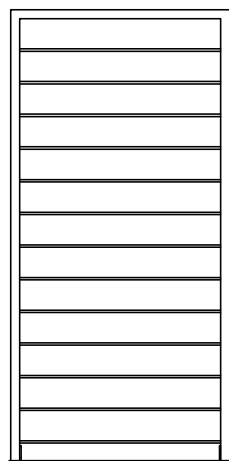
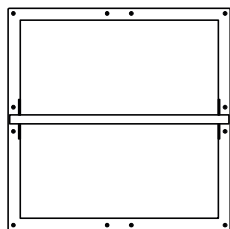

METRIC Trellis

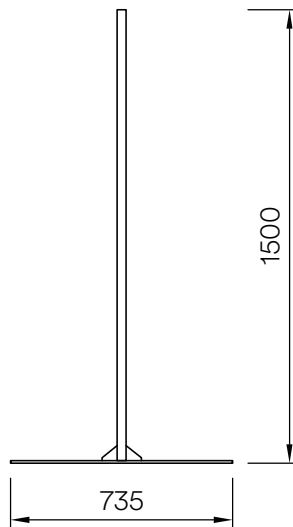

Composition

Frame - Mild steel

Finishes

Mild steel - Hot-dip galvanised (polyester powder-coat available (colour as per client's specification))

Dimensions

Metric L 735mm | width 735mm | height 1500mm

Imperial L 2' 5" | width 2' 5" | height 4' 11"

Approx weight

19kg

Handling

Please observe health & safety lifting guidelines. A forklift or crane will be required for off-loading and positioning of this product.

Maintenance

Depends on usage and position. All elements will require cleaning annually.

Detailed Material & Finish Specifications

Planter Body

- Body assembly comprises of 4 off all welded sections that are bolted together using 12 off M8 x 16mm bolts & nuts.
- Body sections are manufactured from hot-dip galvanised mild steel (polyester powder coat available (colour as per customer specification))
- Planter anchored to ground using 4 no. zinc-coated M10 x 75mm sleeve anchors (one per leg).

Planter Liner

- Liner assembly comprises of 3 off all welded sections that are bolted together using 13 off M6 x 16mm bolts & nuts.
- Manufactured from galvanised mild steel sheet
- Liner bolted to planter using 12 no. M6 x 25mm csk bolts.

Trellis (Optional)

- Manufactured from hot-dip galvanised mild steel (polyester powder coat available (colour as per customer specification)) featuring an all welded construction
- Trellis bolted to planter using the same 12 no. M6 x 25mm csk bolts as liner.

General Maintenance (Recommended Schedule & Guidelines)

Daily/Weekly/Monthly (or as adopted)

Visual checks of planter (and trellis if applicable) - check all items for superficial or physical damage.

Three Monthly

Clean all items as detailed below check all fixings are seated correctly; inspect timber for serious damage and splinters.

Six Monthly

Secure all fixings; full clean as detailed below; check that planter is firmly secured to the ground (and trellis if applicable)

Specific Maintenance Details

Galvanised & Polyester Powder Coated

For general cleaning using a damp cloth and warm soapy water only. Scourers and abrasive cleaners are NOT suitable for this type of finish and may damage it. Before using any cleaning agents to remove graffiti etc. try on a small, inconspicuous area first to avoid causing more unsightly damage.

Repairs

Galvanised & Polyester Powder Coated Surfaces

For light damage (scratches, chips etc.) repair using touch-up paint to match original colour (available from Factory Furniture Ltd). Paint application should be carried out in accordance with approved methods detailed by the paint manufacturer. Please note that it is advisable to use professional painters to achieve best results when touching up larger areas. Products for respraying larger areas are available from Factory Furniture Ltd.

Heavy Damage

In the event of serious damage to any component, replacements should be ordered from Factory Furniture Ltd. Should further assistance be required (or if the product needs to be disassembled for any reason), please contact Factory Furniture for detailed technical advice.

Installation Instructions

ALL INSTALLATION WORKS TO BE CARRIED OUT BY COMPETENT PERSONNEL - INSTALL AS COMPLETE UNIT

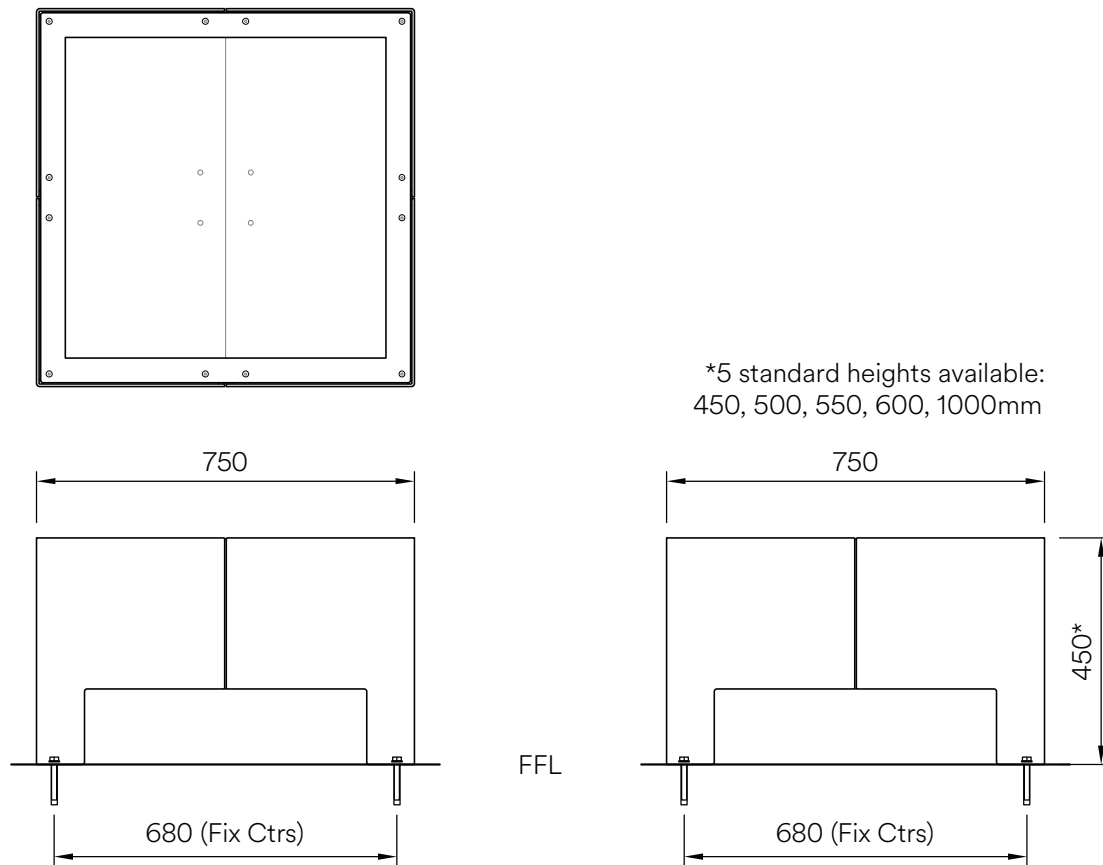

Metric Planter

1. If necessary in order to access base fixing lugs, remove liner from base (12 no. bolts) and put aside carefully.
2. Position planter in desired location then mark leg hole positions onto ground.
3. Remove the planter; drill holes $\varnothing 12\text{mm} \times 90\text{mm}$ deep (or as bolt manufacturer's specs); clear debris from holes.
4. Reposition planter and fix to ground using 4 no. zinc-coated M10 x 75mm sleeve anchors tightened to 50Nm (or as per manufacturer's specs). Ensure base remains level during fixing process.
5. Replace planter liner.

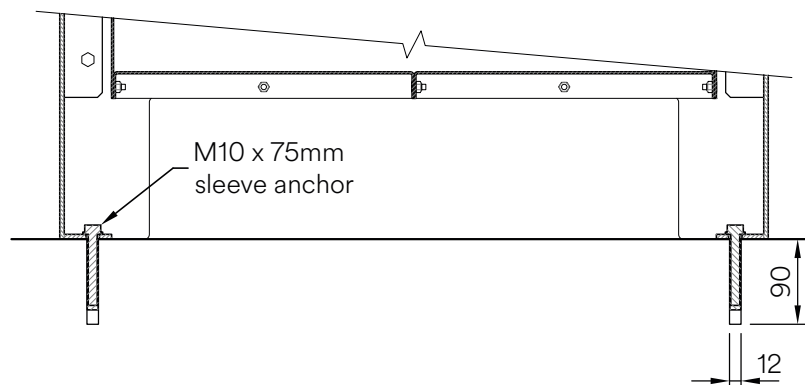

Installation Instructions

ALL INSTALLATION WORKS TO BE CARRIED OUT BY COMPETENT PERSONNEL - INSTALL AS COMPLETE UNIT

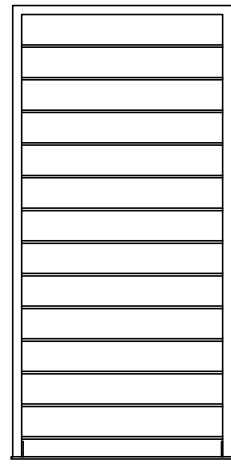
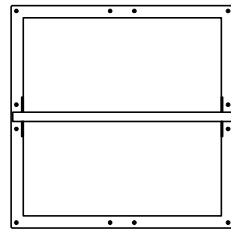

735
METRIC Trellis

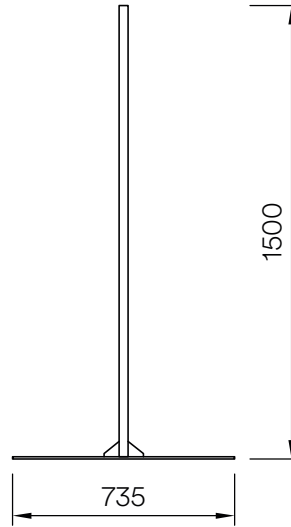

Metric Trellis (Optional)

- Position trellis on planter, aligning holes in trellis and liner.
- Bolt trellis to planter with 12 no M6 x 25 csk bolts provided.

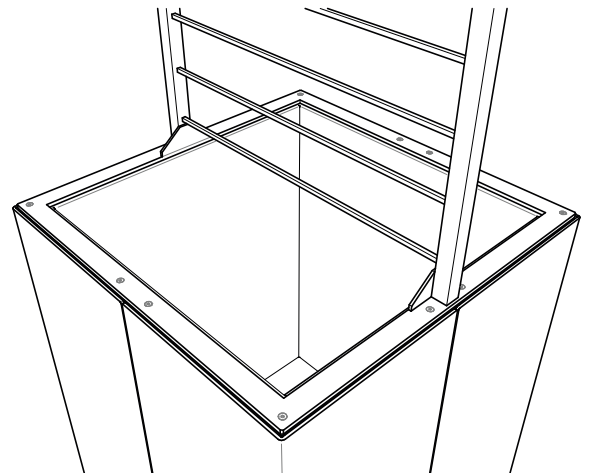
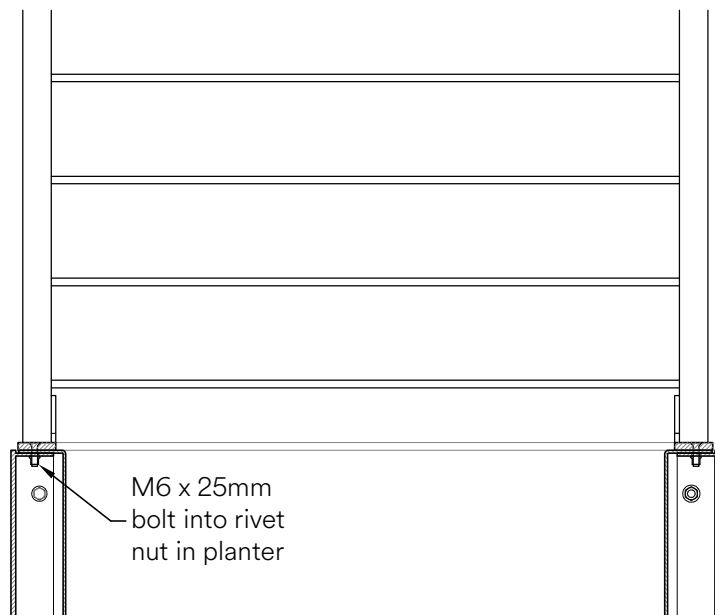

NBS Specification Data

PRODUCT REFERENCE – FF4010 – METRIC PLANTER

Description	Planter with mild steel body and liner (trellis available)
Uniclass 2015 Category	Pr_45_63_63_84 Steel plant containers
Design as per drawing:	FF4010

MANUFACTURER

Name	Factory Furniture Ltd
Address	Unit 5 Pioneer Road, Faringdon, Oxfordshire, SN7 7BU
Website	www.factoryfurniture.co.uk
Telephone	+44 (0)1367 242731

MATERIAL

Planter	Mild steel
Liner	Mild steel
Trellis (Optional)	Mild steel

FINISH

Mild steel	Hot-dip galvanised (option for polyester powder coat)
------------	---

SIZE

750mm x 750mm x 450mm (LxWxH)
750mm x 750mm x 500mm (LxWxH)
750mm x 750mm x 550mm (LxWxH)
750mm x 750mm x 600mm (LxWxH)
750mm x 750mm x 1000mm (LxWxH)

735mm x 735mm x 1500mm (LxWxH) - Trellis (optional)

FIXING

Free standing