

# FACTORY FURNITURE



TREE Table

# Introduction

## Design

Design, shop drawings and development by Factory Furniture Ltd

## Manufacture

Factory Furniture manufactured components. Products are assembled in Factory workshops, checked and dispatched ready for installation. Replacement products or components should be ordered direct from Factory Furniture Ltd.

## Copyright

The design copyright for the product and drawing copyright remains the sole property of Factory Furniture Ltd.

# Contents

## Spec Sheet

TREE Table	... 3
TREE Picnic Set (Access)	... 4
TREE Picnic Set (Stools)	... 5

Detailed Materials	... 6
--------------------	-------

## Installation Instructions

TREE Table	... 7
TREE Picnic Set (Access)	... 8
TREE Picnic Set (Stools)	... 9

## NBS Specifications

TREE Table	... 10
------------	--------

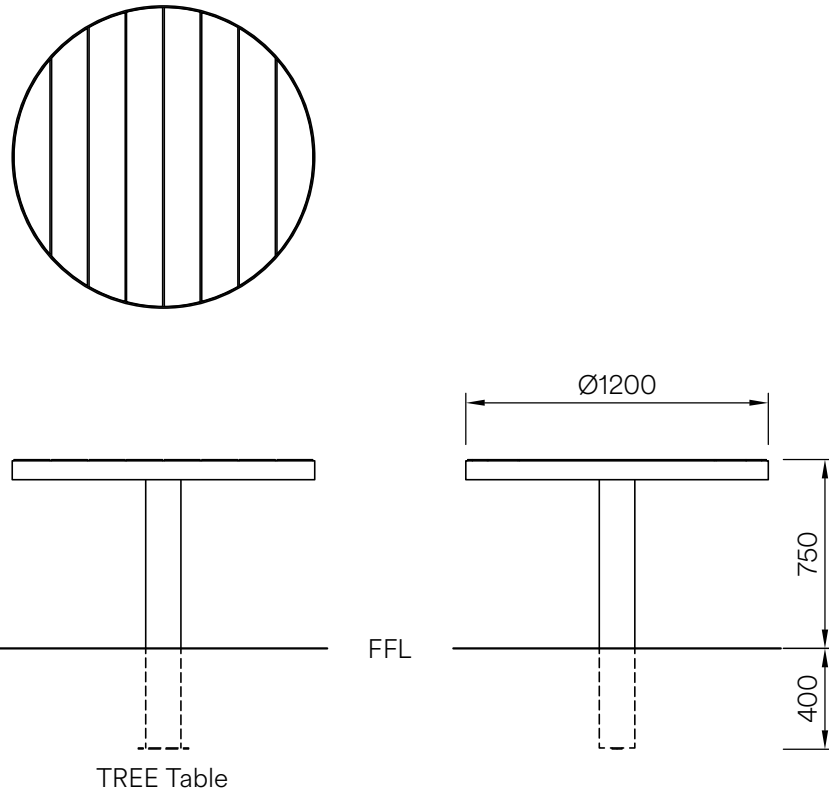

## Composition

Slats - FSC® certified hardwood

Frame - Stainless steel

## Finish

Timber - Untreated sanded finish as standard

Stainless steel - Satin polished finish

## Dimensions

Metric D 1200mm | height 750mm\*

Imperial D 3' 11" | height 2' 5½"

\*Not including +400mm (1' 4") below ground level

## Approx weight

67kg

## Fixing method

Root fixed 400mm (1' 4") below ground level

## Foundation

1 no. 500 x 500 x 500mm pad in C20 concrete (recommendation only)

## Handling

Please observe health & safety lifting guidelines. A forklift or crane will be required for off-loading and positioning of this product.

## Maintenance

Depends on usage and position. All elements will require annual cleaning. Stainless steel requires no further maintenance

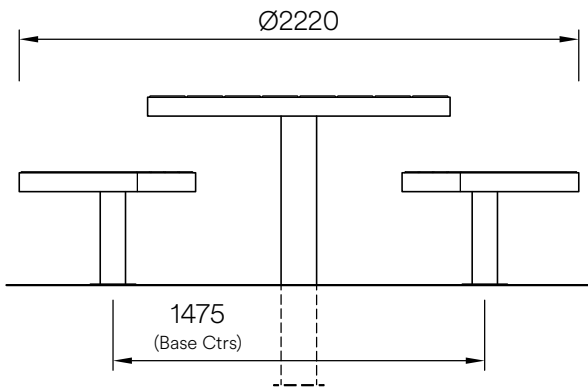
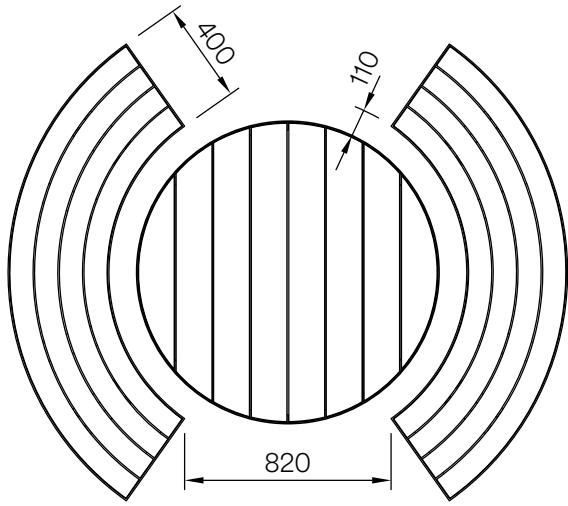

TREE Picnic Set (Access)

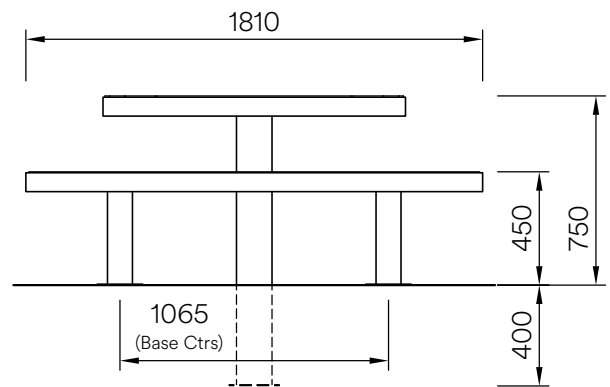

## Composition

Slats - FSC® certified hardwood

## Finish

Timber - Untreated sanded finish as standard

## Dimensions

Table

Metric D 1200mm | height 750mm\*

Imperial D 3' 11" | height 2' 5½"\*

\*Not including +400mm (1' 4") below ground level

## Approx weight

67kg

## Fixing method

Root fixed 400mm (1' 4") below ground level

## Foundation

1 no. 500 x 500 x 500mm pad for table & 4 no. 400 x 400 x 400mm pads for benches in C20 concrete (recommended)

## Handling

Please observe health & safety lifting guidelines. A forklift or crane will be required for off-loading and positioning of these products

## Maintenance

Depends on usage and position. All elements will require annual cleaning. Stainless steel requires no further maintenance

Frame - Stainless steel

Stainless steel - Satin polished finish

Access Bench

Metric L 1810mm | width 700mm | height 450mm\*

Imperial L 5' 11½" | width 2' 3½" | height 1' 5½"\*

\*Not including +200mm (8") below ground level

47kg each (161kg total)

Root fixed 200mm (8") below ground level

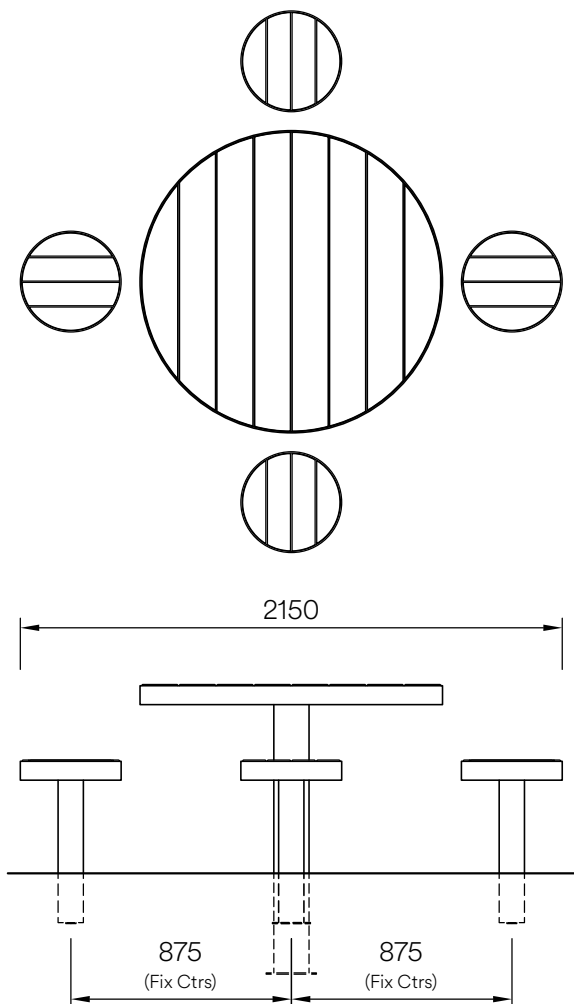

TREE Picnic Set (Stool)

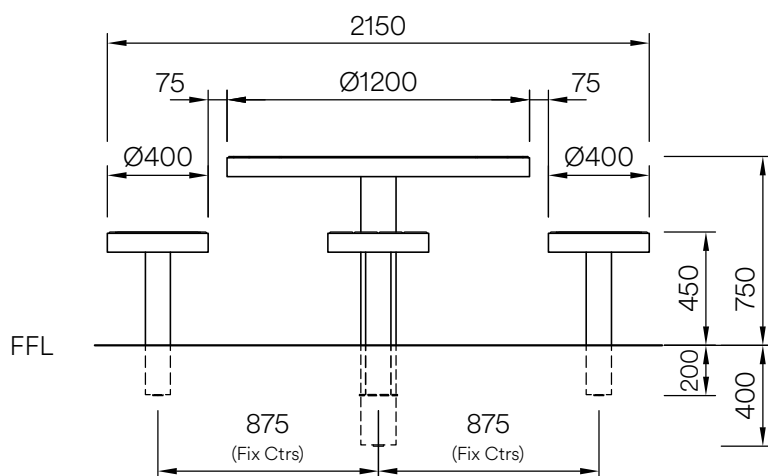

## Composition

Slats - FSC® certified hardwood

## Finish

Timber - Untreated sanded finish as standard

## Dimensions

Table

Metric D 1200mm | height 750mm\*

Imperial D 3' 11" | height 2' 5½"

\*Not including +400mm (1' 4") below ground level

## Approx weight

67kg

## Fixing method

Root fixed 400mm (1' 4") below ground level

## Foundation

1 no. 500 x 500 x 500mm pad for table and 4 no. 300 x 300 x 400mm pads for stools in C20 concrete (recommended)

## Handling

Please observe health & safety lifting guidelines. A forklift or crane will be required for off-loading and positioning of these products

## Maintenance

Depends on usage and position. All elements will require annual cleaning. Stainless steel requires no further maintenance

Frame - Stainless steel

Stainless steel - Satin polished finish

Stool

Metric D 400mm | height 450mm\*

Imperial D 1' 3½" | height 1' 5½"

\*Not including +200mm (8") below ground level

13kg each (119kg total)

Root fixed 200mm (8") below ground level

# Detailed Material & Finish Specifications

## Timber Slats

- Manufactured from FSC® certified hardwood
- Profiled and left untreated as standard
- Mounted on and screwed to frame

## Base / Frame (Table & Seating)

- Manufactured from stainless steel with satin polished finish
- Frame and base assemblies all feature an all welded construction. Bases bolt on to frames for ease of transport
- Table & stool bases only - 'T' bar at foot of base for better anchorage in foundation pad
- Table & stool bases only - Root fixed below ground level
- Access bench option - Bench bases anchored via 8 no. M10 x 130mm resin anchor studs and cap nuts (2 per base)

# General Maintenance (Recommended Schedule & Guidelines)

## Daily/Weekly/Monthly (or as adopted)

Visual checks of table (and benches / stools if incl.) top and base - check all items for superficial or physical damage.

## Three Monthly

Clean all items as detailed below check all fixings are seated correctly; inspect timber for serious damage and splinters.

## Six Monthly

Secure all fixings; full clean as detailed below; check that table / seating is firmly secured to the ground

# Specific Maintenance Details

## FSC Timber

Clean with a stiff brush once per year, especially in more exposed locations, in order to prevent a verdigris type build up on the timber surface. Ideally this should be completed in early spring. During the cleaning stage, all exposed timber surfaces should be inspected for splits and splinters. Any splinters and graffiti should be removed and the surface sanded with 100 grit sandpaper in order to remove any uneven / sharp edges or surfaces.

During the first few months after installation the tannin naturally occurring in the timber may leach out and cause a brown staining on the bases. This may be removed with a light solution of household bleach and water.

## Stainless Steel (polished stainless steel only)

Clean as required, but at least every three months. For stainless use a stainless steel polish and a lint free cloth. To remove ground in dirt, a stainless steel finishing pad may be required.

# Repairs

## FSC Timber

For light damage, please see section on specific maintenance details above. For instances of heavy damage, the timber item should be replaced. Please order against the part number reference in the reordering section towards the end of this manual.

## Stainless Steel

Light damage (surface scratches etc.) can be removed using an emery pad (240 grit) and freeing oil such as 'WD40'. Care should be taken to follow the direction of the brushing grain. It is recommended that a trial repair be carried out on an unimportant surface first. No corrosive cleaners or other abrasives should be used. Any contamination, particularly carbon steel scuffs from vehicles, should be quickly removed to avoid corrosion.

## Heavy Damage

In the event of serious damage to any component, replacements should be ordered from Factory Furniture Ltd. Should further assistance be required (or if the product needs to be disassembled for any reason), please contact Factory Furniture for detailed technical advice.

# Installation Instructions

ALL INSTALLATION WORKS TO BE CARRIED OUT BY COMPETENT PERSONNEL - INSTALL AS COMPLETE UNIT

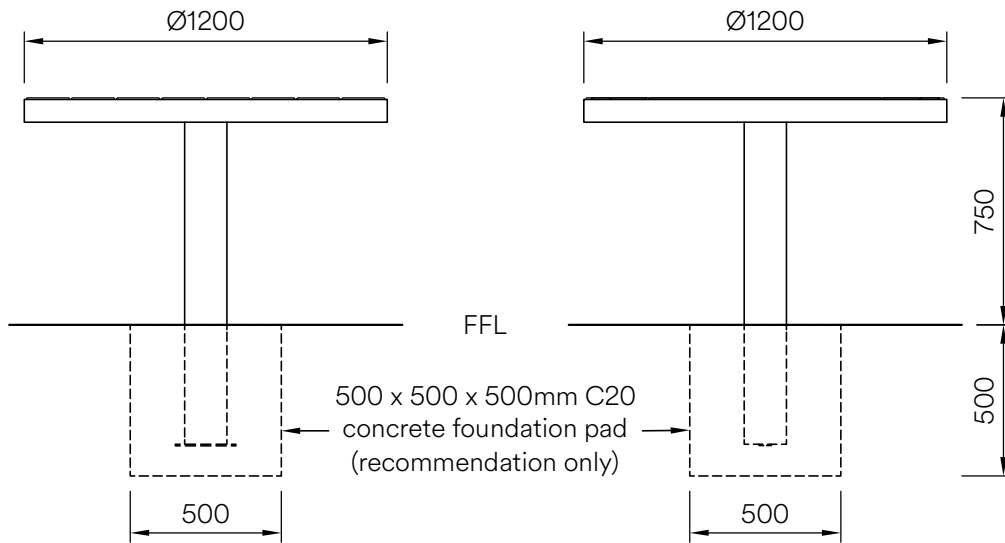

## Tree Table (sub-surface fix only)

1. Install suitable foundation pad (see illustration) with top face at ground level
2. As soon as possible after pouring concrete for pad, position table in correct orientation with base centrally in foundation pad. Keep table vertical and at correct height (table top @ 750mm above ground level) whilst concrete sets (at least 24 hours).

## IMPORTANT NOTE

Ensure that stainless steel is protected during site cutting of stone – contamination from disc cutters will produce corrosion on stainless steel components.

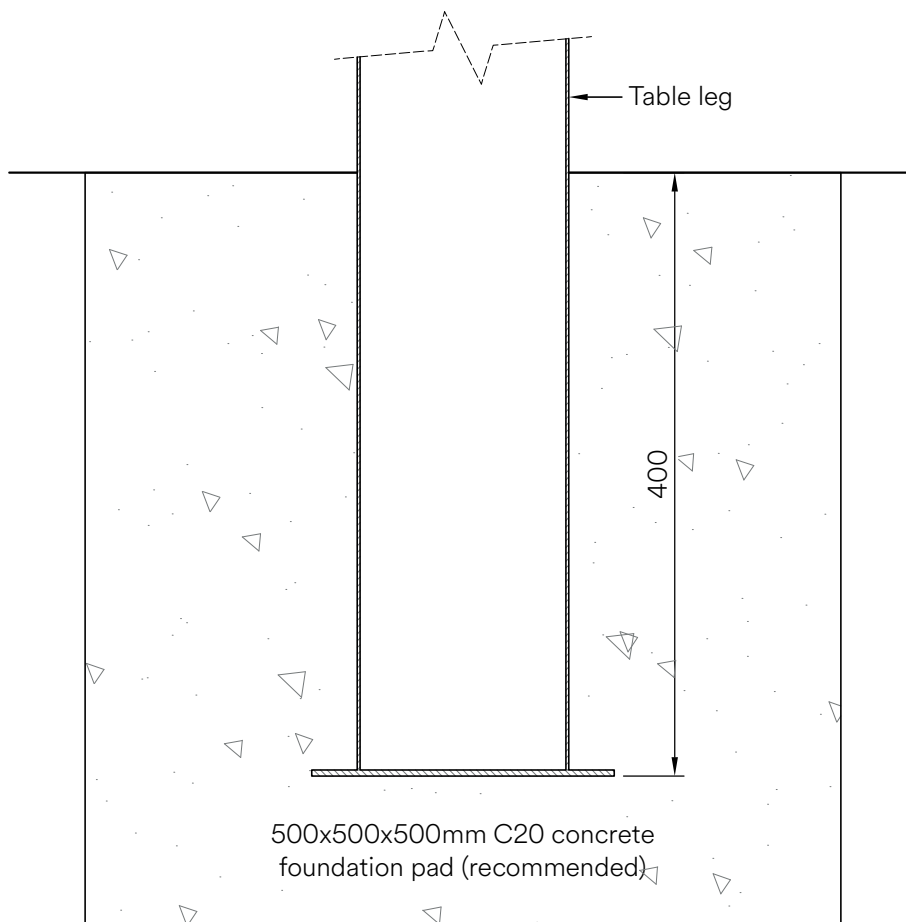

# Installation Instructions

ALL INSTALLATION WORKS TO BE CARRIED OUT BY COMPETENT PERSONNEL - INSTALL AS COMPLETE UNIT

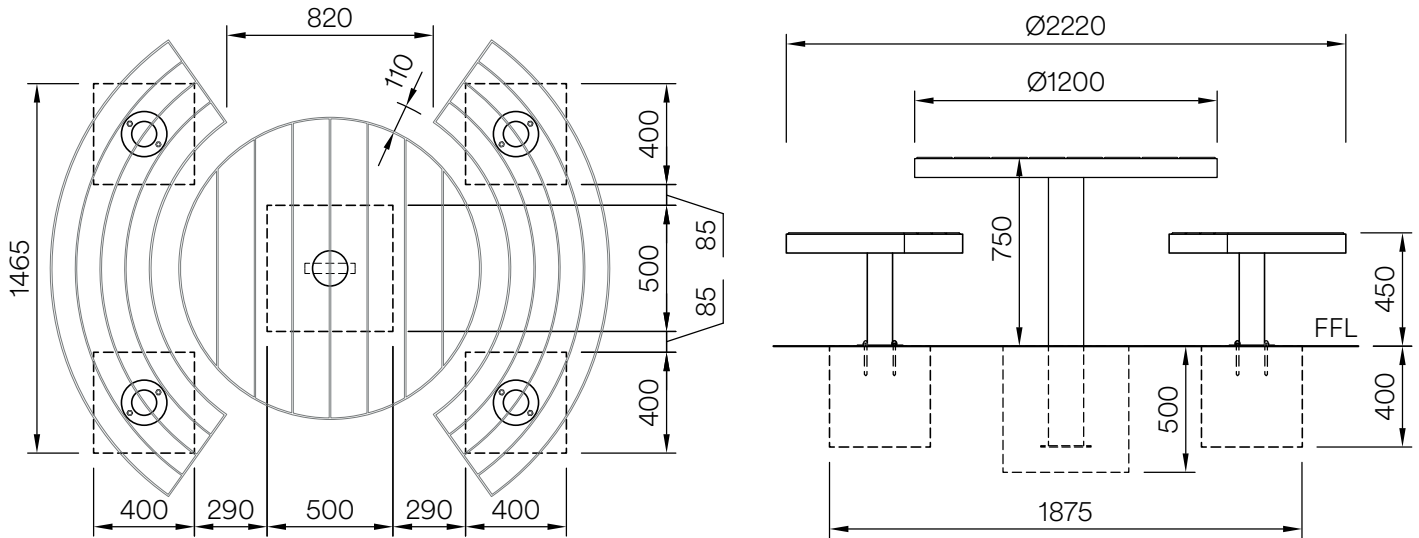

## Tree Table Picnic Set (Access Option)

1. For installing table (see pg 7)
2. Install suitable foundation pads (see illustration) each with top face at ground level and leave to set (24hrs min)
3. Position benches in correct orientation with bases centrally on foundation pads; then mark hole positions through base plates.
4. Remove benches; drill holes  $\text{Ø}14\text{mm}$  x 130mm deep and clear debris from holes.
5. Fill holes to within approx. 35mm from the top with Hilti HY150 resin (or similar).
6. Move benches back into position and drop resin anchor studs (with capnuts on top but not tightened all the way) into the holes - leave for two hours to cure before proceeding (or as per resin manufacturer's instruction)
7. Using a torque wrench, tighten nuts to 20Nm to fasten down the benches and check levels.

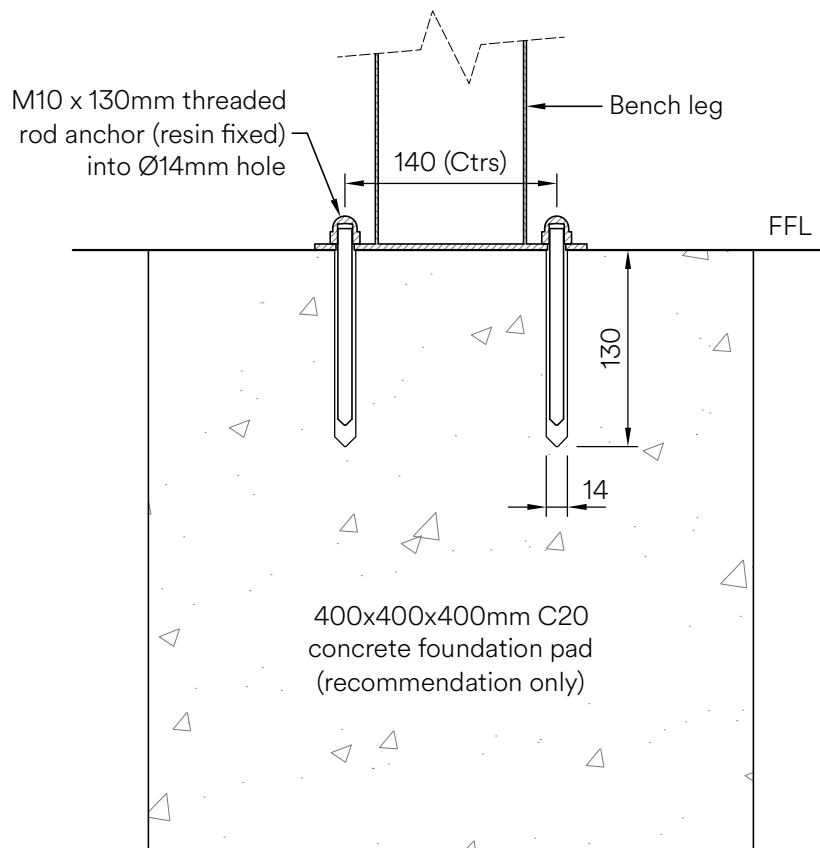



# NBS Specification Data

## PRODUCT REFERENCE – FF2003 – TREE TABLE

Description Table with stainless steel frame and timber slats  
Uniclass 2015 Category Pr\_40\_30\_30\_86 Street and site tables  
Design as per drawing: FF2003

### MANUFACTURER

Name Factory Furniture Ltd  
Address Unit 5 Pioneer Road, Faringdon, Oxfordshire, SN7 7BU  
Website [www.factoryfurniture.co.uk](http://www.factoryfurniture.co.uk)  
Telephone +44 (0)1367 242731

### MATERIAL

Slats FSC® certified hardwood  
Frame & bases Stainless steel

### FINISH

Timber Untreated sanded finish as standard  
Stainless steel Satin polished

### SIZE

Table only (FF2003) Ø1200mm x 750mm (DxH)  
Picnic Set (Access) (FF2003-PA) 2220mm x 1810 mm x 750mm (LxWxH)  
Picnic Set (Stools) (FF2003-PS) 2150mm x 2150 mm x 750mm (LxWxH)

### FIXING

Table & Stools Root fixed  
Access 8 off resin fixed anchors (4 per bench)